

## 6. Plumbing the system – and let the Aqua-Pure water flow

1. Measure a length of white tubing, to run from fitting (6) on faucet to white outlet connection (2e) on head assembly (2). Push tubing firmly into faucet fitting (6), ensuring it is fully seated. Push other end into the outlet elbow connection (2e) on head assembly (2).
2. Measure another length of tubing to connect from blue inlet connection (2d) on head assembly (2) to isolation tap (4) on MFCV (5), previously installed.
3. Turn faucet to on position. Turn water supply on slowly to release any air trapped in the system. Turn faucet off.
4. Neatly fix water tubing to cupboard walls with plastic clips and screws provided.
5. Turn faucet on to run water through system for 3 minutes to flush superficial dust and fines from the system. The water may appear “milky”; this is normal and is caused by tiny air bubbles being expelled from the cartridge. You may flush water through the system until the water appears clear, or use the system and this condition will clear itself.

The Aqua-Pure AP8000 water filter system is now ready to produce Sparkling Clean and Great Tasting Water for you and your family’s protection and enjoyment.

### WARRANTY

The Aqua-Pure Premium AP8000 water filter system is designed to operate at a maximum pressure of 900kPa (130psi) and at a maximum temperature of 40°C. Cuno Pacific Pty Ltd warrants this filter system to be free from defects in material and workmanship for a period of one year from the date of purchase (warranty period does not apply to cartridge which is consumable). This warranty is expressly limited to the repair or replacement at our premises of any part or parts proving defective providing the housing has been installed in accordance with our Installation Instructions all relative plumbing codes, the installation of an approved pressure limiting device preceding the filter, and the pressure and temperature do not exceed the limits stated herein. This warranty does not extend to mechanical damage caused during installation or use. Save insofar as they may be excluded by law, this warranty is given in lieu of all other expressed or implied warranties or conditions and Cuno Pacific Pty Ltd shall in no event be held liable for damages or delays caused by defects and assumes no responsibility for unauthorised repairs.

Cuno Pacific Pty Ltd

**CUNOCare**  **1300 FILTER**  
3 4 5 8 3 7



cunoau@mmm.com  
www.cuno.com.au

 **1800 671 599**



# Aqua-Pure®

WATER PURIFIERS

# AP8000

## single undersink water filter system installation and operating instructions

### The Basics!

#### Not even an Aqua-Pure filter can make unsafe water safe

The AP8000 water filter system should only be used on water that is microbiologically safe – that is, water that has been adequately chlorinated or disinfected. Additional equipment (such as a chlorine injection system or an ultraviolet steriliser) will be required for unsafe water.

#### It works best when it's used

If the Aqua-Pure water filter system has not been used for more than one day, you will need to flush 1 to 2 litres of water through the system before using the water. The AP8000 requires a minimum water supply pressure of 100kPa (14psi) and not exceed a maximum water pressure of 900kPa (130psi). A 600kPa (87psi) Pressure Limiting Valve must be installed on the inlet side of this system (see below).

#### What a Valve

The AP8000 system has been supplied with an Aqua-Pure 98210 Multi-Function Control Valve (MFCV) as standard equipment. This valve must be installed as detailed in the Installation Drawings and Instructions, to provide:

- Flow Restriction
- Pressure Limiting
- Dual Check Backflow Prevention
- Anti-Hammer Protection to the filter system.

This valve is fitted with a Particle Removal Screen on the inlet side to protect the intricate mechanism from debris that may be in the water supply. This screen must remain in place at all times. Failure to comply with these requirements will void the warranty.

#### Have a change of heart every 12 months

The heart of an AP8000 filter system is the AP8112 filter cartridge, which has a recommended maximum life of 12 months. The life and performance of a cartridge may vary depending on the volume and quality of the incoming water supply being filtered. Your cartridge may need replacing earlier than 12 months if you notice a reduced volume or flow from the filter faucet, or the return of an unpleasant taste/odour to the filtered water.

#### Worth doing...worth doing properly

Installation of the AP8000 filter system must comply with any existing State or Local Plumbing codes, some of which require installation by a licensed plumber. For correct operation of this appliance, it is essential that these Installation and Operating Instructions be strictly observed.

## Installation instructions:

### 1. Your Aqua-Pure AP8000 component identification & content check list:

Ref	Description	Qty	Part No.
1	Cartridge AP8112	1	41-AP8112-1
2	System head assembly	1	-
Components;			
2a	head	1	41-68375-01
2b	mounting bracket	1	240490-00
2c	1/4" x 3/8" quick connect adaptor	2	13-QS1438NMW
2d	1/4" quick connect elbow with blue collet (inlet)	1	13-1414SWB
2e	1/4" quick connect elbow with white collet (outlet)	1	13-1414SW
2f	Cartridge locking button	1	-
3	High Pressure Tubing 1/4" O.D x 2 metres	1	41-10-303W
4	Isolation Tap 1/4" NPT x 1/4" tube	2	98213
5	Multi-Function Control Valve (MFCV)	1	98210-03
5a	Black Stopper Plug	1	-
6	Quick Connect Faucet Connector 1/4" x 7/16" UNSF-24	1	98020
7	Deluxe Swivel Long Reach Faucet	1	13-FLRTAP-AP
8	Compression Tee 1/2" BSP (F)	1	98014-N
9	Nipple 1/2" BSP x 1/2" BSP (M)	1	98047
10	Hex Key 8mm	1	98218
*	Plastic Clips for Tubing	4	25-HE3304
*	Screws 10G x 3/4" P/H Self Taping (for plastic clips)	4	98024
11	Thread Seal Tape	1	98224

\*not shown

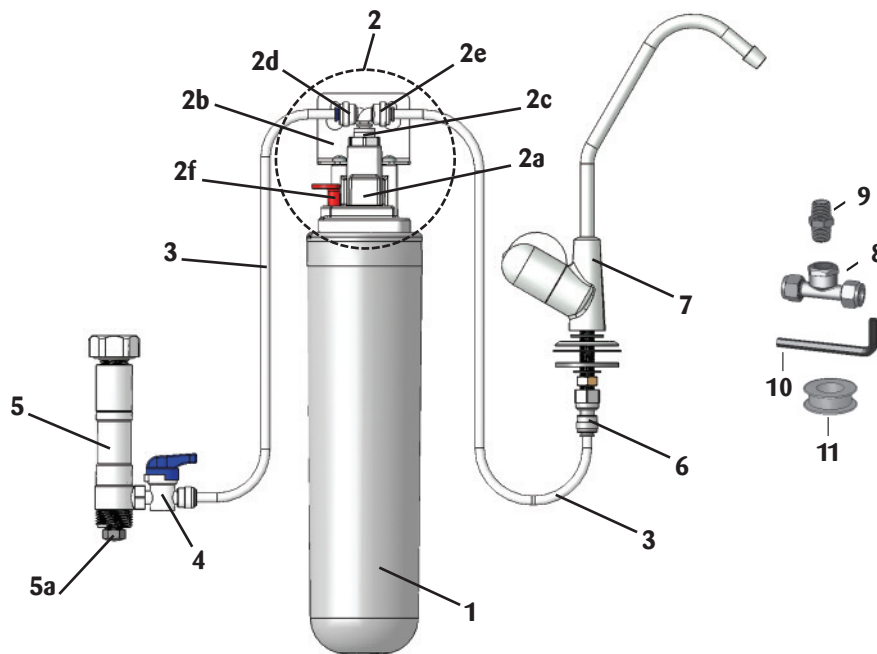

### 5. Mounting the system

1. Mark location of fixing holes (ref fig 23) and fix unit to cupboard with mounting screws provided (ref fig 24). Remember, approximately 40mm space must be provided below the bottom of the cartridge, to allow removal.

fig 23.

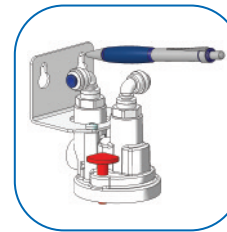
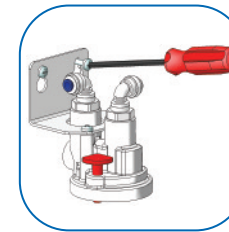
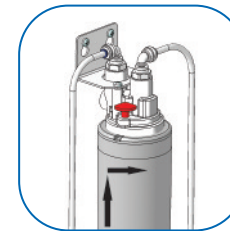

fig 24.



2. Remove protective red cap from cartridge (1). Align centre of label on cartridge (1) with red locking button (2f) on head (2), push cartridge (1) into head firmly and turn to right (ref fig 25). Listen for the click of locking button (2f).

fig 25.



3. Determine suitable location on sink or benchtop for Chrome Faucet (7). Drill a 12mm hole (ref fig 26).

HELPFUL HINT: For mounting in stainless steel sink, we suggest placing masking tape over drill spot to prevent drill movement. Drill 3mm pilot hole, followed by 12mm hole for faucet shaft. It is advisable to use good quality, sharp drill bits.

fig 26.

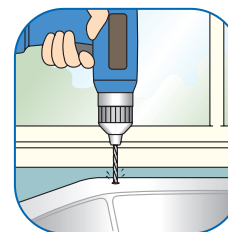

4. Place small rubber washer, chrome escutcheon and large rubber washer on shaft of faucet (ref fig 29). Insert faucet shaft into the hole you have just drilled (ref fig 27).

fig 27.

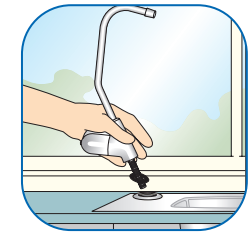

5. Place large plastic washer, metal locking washer and lock nut on undersink side of faucet shaft (ref fig 29), tighten nut and ensure faucet handle is pointing in desired direction (ref fig 28).

fig 28.

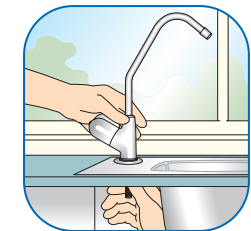

6. Screw Quick Connect Faucet Connector (6) onto the end of faucet shaft. This fitting does not require thread tape and should be tightened, so it does not leak.

fig 29.

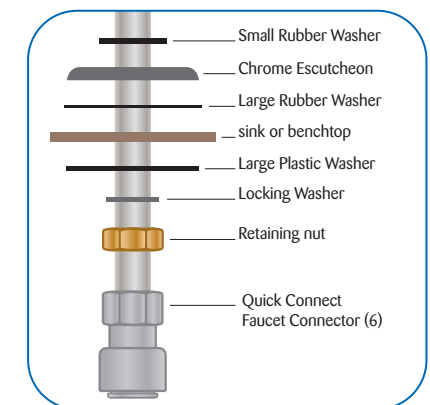

#### 4c. Connecting to 1/2" copper pipe (ref fig 4)

Some installations have 1/2" copper pipe exiting the wall and proceeding directly to the cold water tap on the sink. In this situation, it will be necessary to cut the copper pipe and insert the brass tee provided.

1. Locate cold water pipe. Turn water supply off. If there is not an isolation tap handy, turn off at the meter. Turn on tap at sink to be sure water is turned off.
2. Find a suitable, straight section of pipe where the brass tee can be inserted. Make two cuts using a pipe cutter or hacksaw and remove a sufficient length of copper pipe to insert tee.
3. Remove the two compression nuts and olives from brass tee (8). Place a compression nut and an olive on each pipe end. Place body of tee piece onto pipe and slide olive and nut up to each side of the tee (8); tighten compression nuts onto body of tee piece to prevent leaking (ref fig 16).

fig 16.

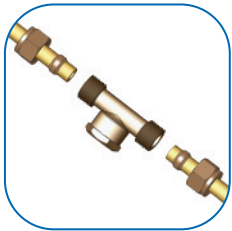

4. Using brass nipple (9), tape thread and screw into internal threaded outlet of tee piece (ref fig 17).

fig 17.

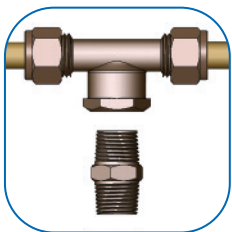

5. Take MFCV (5) and, with Hex Key (10), unscrew inlet nut by placing the Hex Key (10) in key provision in inlet spinning nut adaptor and unscrew by turning anti-clockwise (ref fig 18).

fig 18.



6. Screw MFCV (5) to nipple (9) in tee piece. Ensure Particle Screen is fitted to entry point of MFCV (5) (ref fig 19).

fig 19.

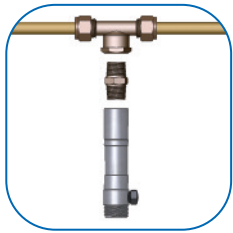

7. Using thread tape, thread tape the isolation tap (4) (ref fig 20). Select port you want to use and screw the isolation tap (4) into the port. Thread tape black Stopper Plug (5a) and screw into un-used port (ref fig 21).

CAUTION! Do not use tools or overtighten, hand tighten MFCV (5) and Black Stopper Plug (5a) only.

fig 20.

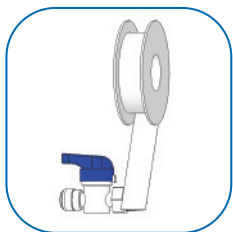
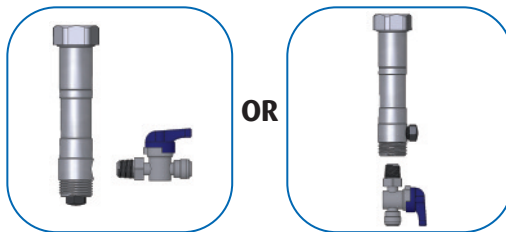

fig 21.



#### 2. The Quick Connect Push-In system

All fittings provided for the water tubing are "Quick Connect Push-In Fittings", which do not require any tools or sealing materials.

to connect

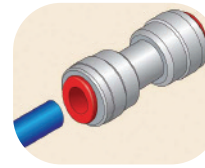

Cut end of tube square

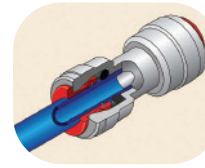

Insert and seat firmly

to disconnect

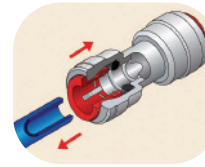

press and hold collet against fitting, pull tube out of fitting

#### 3. Decide where your Aqua-Pure system should be installed before working out how

Choose a suitable area within the cupboard under the sink to mount the AP8000 water filter system see fig 1.

fig 1.

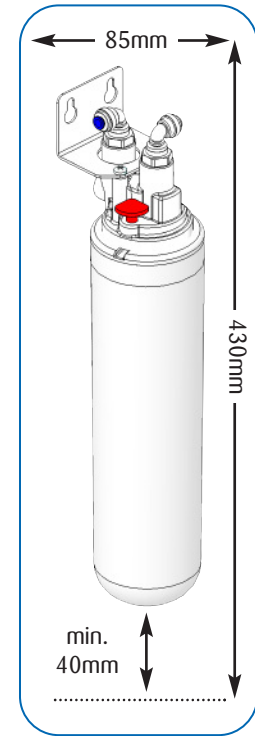

#### 4. Water supply – 3 options

The Plumbing Installation Kit supplied with the AP8000 water filter system provides fittings for the following plumbing configurations under the sink, determine the method to best suit your installation:

Installation with a dishwasher

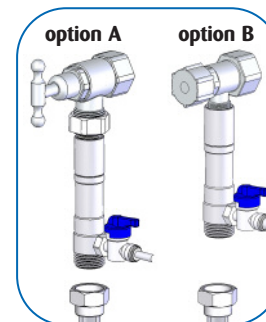

fig 2.

Installation with a mixer tap

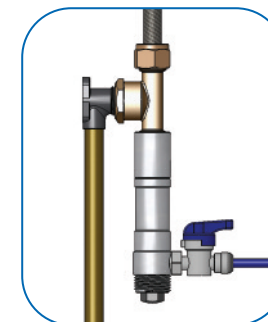

fig 3.

Connecting to 1/2" copper pipe

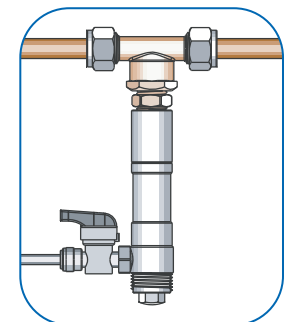

fig 4.

**4a. If you have a cold water feed to a dishwasher and you're a handy man it's not such a big job** (ref fig 2)

**CAUTION: If the dishwasher is connected to hot water you cannot proceed to connect the water filter system by this method.**

If the dishwasher is connected to cold water or there is an additional cold water tap provided, proceed as follows:

1. Turn water supply tap off, remove dishwasher connecting hose from tap.
2. Thread tape Isolating Tap (4) with thread tape supplied (ref fig 5). Remove stopper plug (5a) from the Multi-Function Control Valve (MFCV) (5) (ref fig 6) and screw Isolating Tap (4) into side outlet port of MFCV (5) until it is tight enough so it will not leak (ref fig 7).

fig 5.

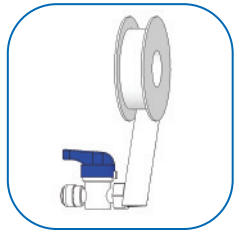

fig 6.



fig 7.



**Option A; (ref fig 2)**

1. Screw MFCV (5) onto water supply tap with inlet spinning nut (ref fig 8). Ensure rubber washer is fitted into tap entry nut. Hand tighten sufficiently to avoid leaking.

fig 8.

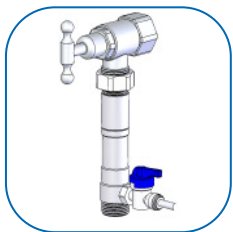

**Option B; (ref fig 2)**

1. Take MFCV (5) and with Hex Key (10) provided, unscrew inlet nut by inserting Hex Key (10) in key provision in inlet. Once in place, turn Hex Key (10) anti-clockwise to unscrew adaptor nut (ref fig 9).

fig 9.



2. Screw MFCV (5) to water supply tap. Hand tighten sufficiently to avoid leaking (ref fig 10).

fig 10.

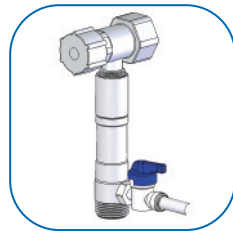

3. Reconnect dishwasher hose to end of MFCV (5). CAUTION! Do not overtighten MFCV.

**4b. Installation with a mixer tap (ref fig 3)**

1. Locate the cold water supply outlet. If the outlet has a tap, turn it off. If it has a compression fitting with no tap, the water supply must be turned off at mains or entry to building.
2. Disconnect flexible connection hose from the cold water supply outlet.
3. Remove the two compression nuts and olives from the brass tee provided (ref fig 11). Wrap cold water outlet and both ends of tee with thread tape. Screw tee to cold water outlet using the centre female outlet with the internal thread.

fig 11.

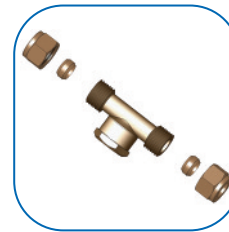

4. Take MFCV (5) and, with Hex Key (10), unscrew inlet nut by placing the Hex Key (10) in key provision in inlet spinning nut adaptor and unscrew by turning anti-clockwise (ref fig 12).

fig 12.



5. Reconnect the flexible connection from the mixer tap to the tee (8) and connect MFCV (5) to the other end of tee (ref fig 13).

fig 13.

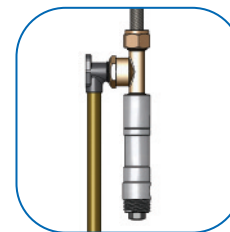

6. Using thread tape, thread tape the isolation tap (4) (ref fig 14). Select port on MFCV (5) you want to use and screw isolation tap (4) into this port until it is tight. Thread tape black stopper plug (5a) and screw into un-used port (ref fig 15). Tighten both isolation tap (4) and stopper plug (5a) sufficiently, to avoid leaking.

fig 14.

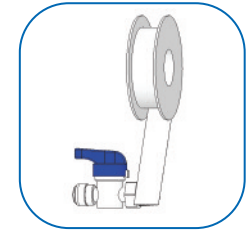

fig 15.

